

SCALE: 1/4" = 1'-0"

- NOTES:**
- 1) GENERAL CONTRACTOR TO VERIFY OPENING DIMENSIONS W/ SELECTED WINDOW MANUFACTURED BEFORE POURING EXTERIOR CONCRETE WALLS.
 - 2) REFER TO DOORS & WINDOW PRODUCT APPROVALS FOR APPROPRIATE FACING.
 - 3) RAILING, WINDOW, EXTERIOR DOORS, STAIRS & HURRICANE SHUTTERS REQUIRE PRODUCT CONTROL APPROVAL (NOA'S) & SEPARATE PERMITS (APPROVAL IN COUNTY)
 - 4) SEE EMERGENCY ESCAPE & RESCUE NOTES (SECTION 1029) ON SHEET AA.00
 - 5) SEE DETAILS AND INFORMATION ON SHEET AX.XX.

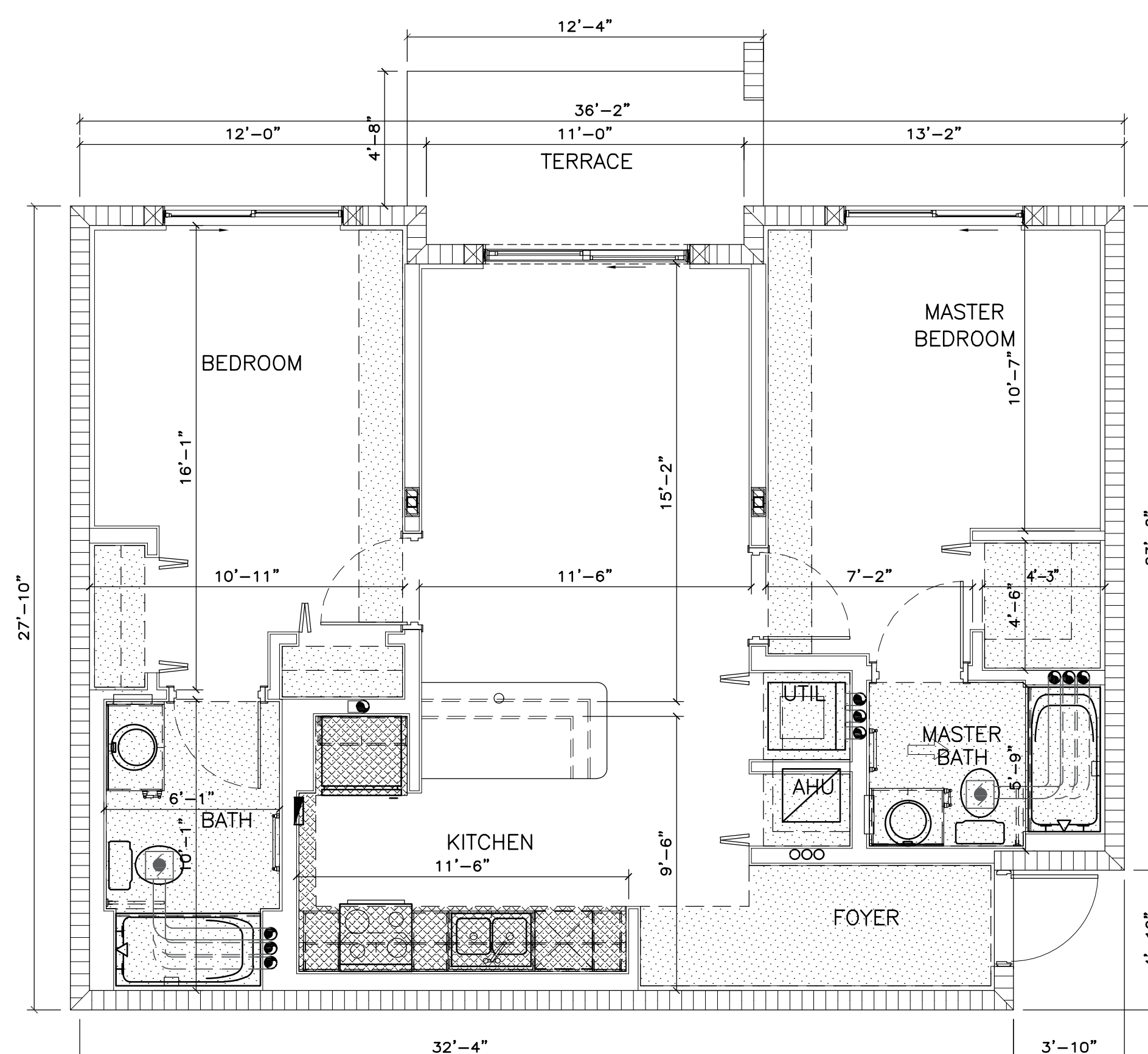

A/C AREA 1,268 S.F.

SCALE: 1/4" = 1'-0"

A/C AREA	982 S.F.
----------	----------

SCALE: 1/4" = 1'-0"

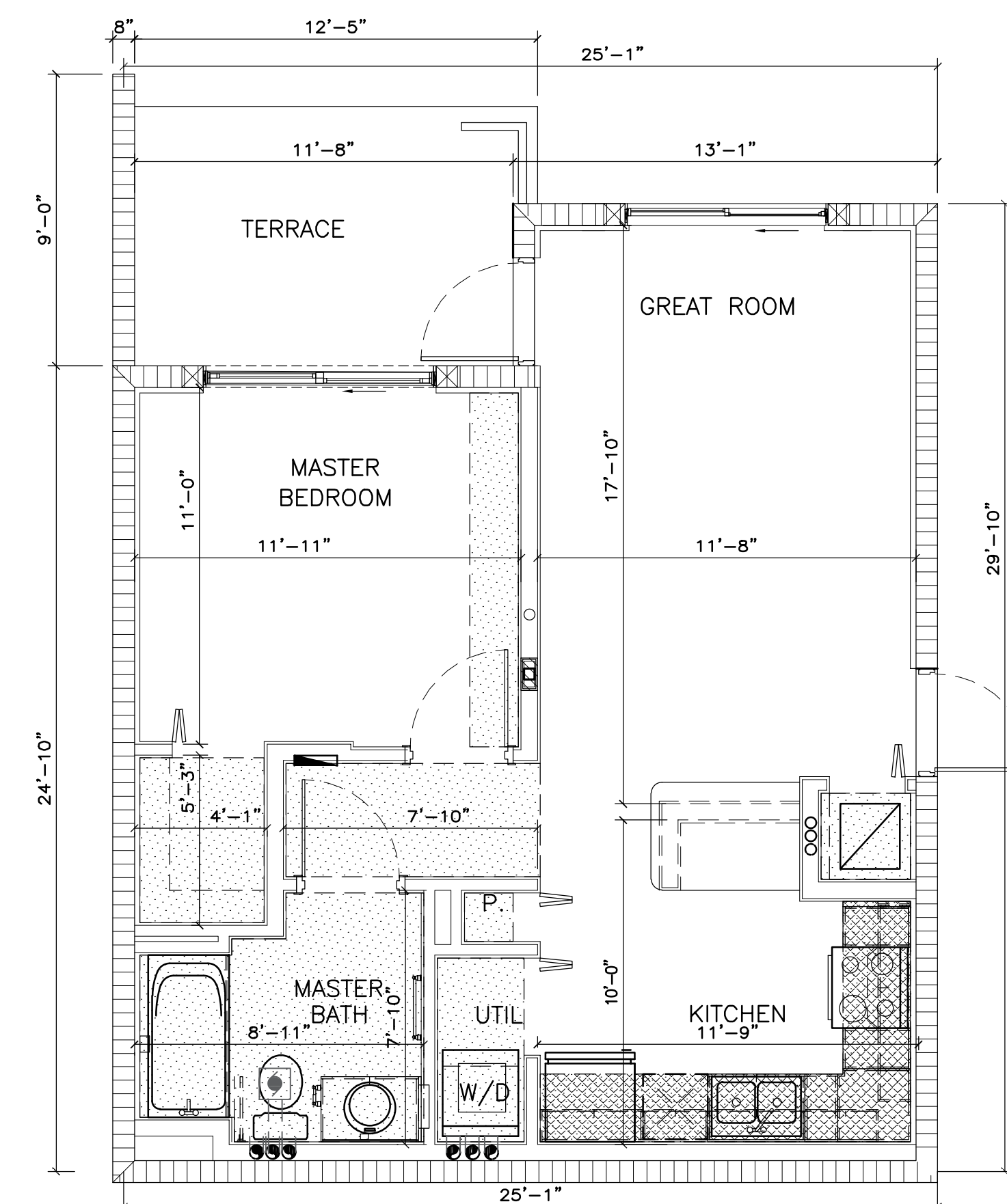

A/C AREA	687 S.F.
----------	----------

SCALE: 1/4" = 1'-0"

[illegible]

2203

GATEWAY LUXURY APARTMENTS

LOCATED AT:
950 N POWERLINE
POMPANO BEACH FL

BURGOS LANZA & ASSOCIATES
1248 S ALHAMBRA CIRCLE
CORAL GABLES, FL 33146

VIA 38052598
WWW.BURGOSLANZA.COM

**BURGOS
LANZA**
ARCHITECTS & PLANNERS

AA 26001519
 PABLO BURGOS ARCHITECT AR 0095925
 CARLOS LANZA ARCHITECT AR 0016081
 THE ARCHITECTURAL DESIGN AND DETAIL DRAWINGS ARE THE LEGAL PROPERTY OF BURGOS LANZA ARCHITECTS AND ARE

Pablo Burgos

Digitally signed by Pablo Burgos:
DN: cn=Pablo Burgos, o=Burgos
Lanza & Assoc., ou=AR95925,
email=pburgos@burgoslanza.co
m, c=US
Date: 2023.05.11 14:47:18 -0400

DATE	11/09/21
DRAWN	CR
PROJECT No.	2203
SCALE	AS-SHOWN

UNITS

SCALE 1/4" = 1' - 0"

~~A400~~

DRC

PZ22-12000008
6/15/2022